

35M NOMINAL HEIGHT

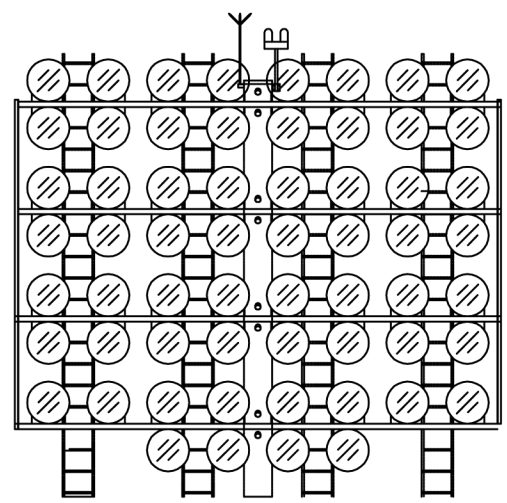

HEADFRAME FOR 60 NOS. FLOODLIGHTS

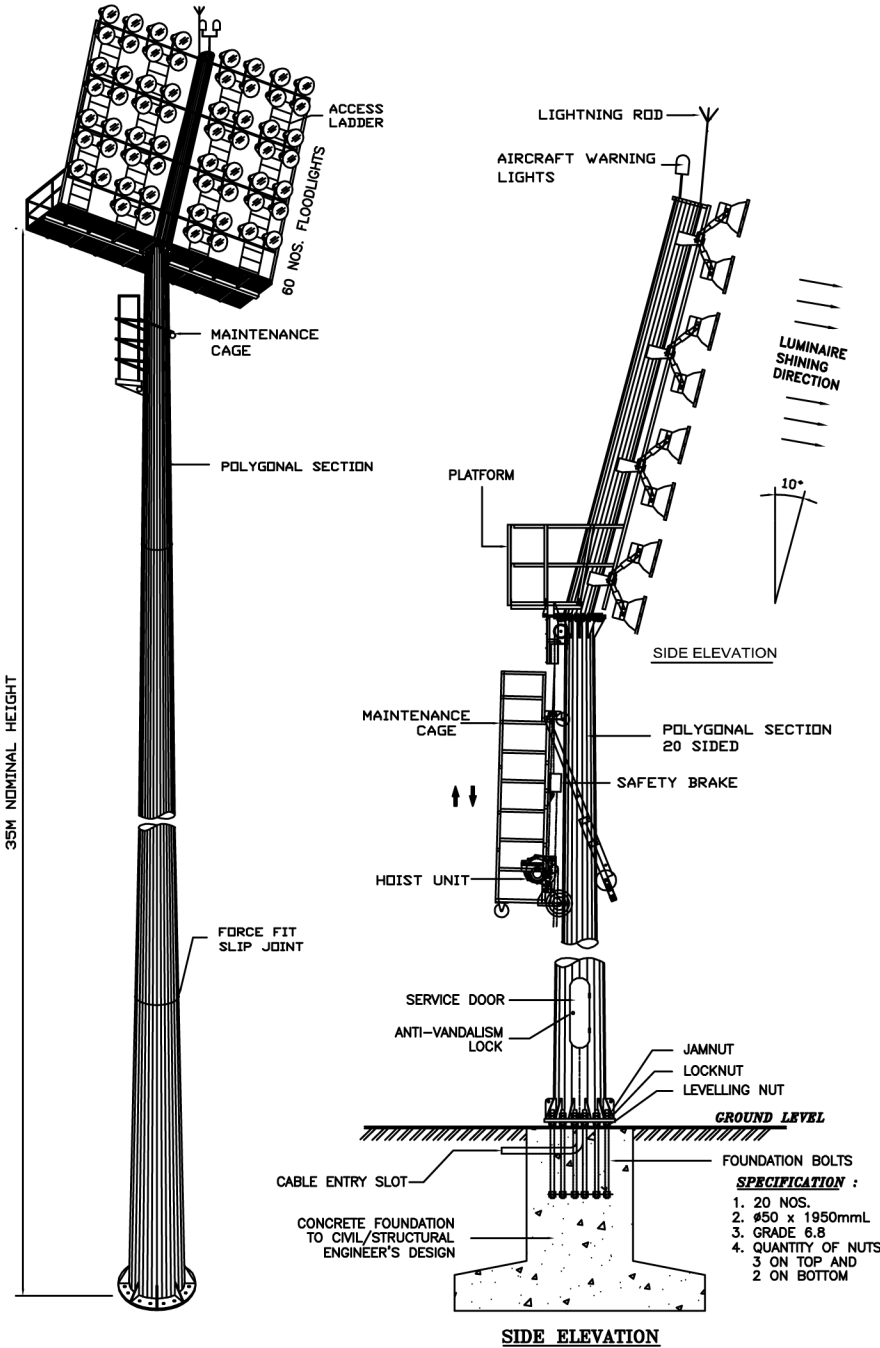
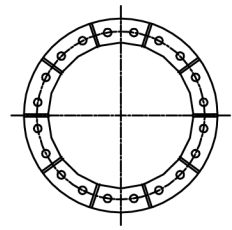
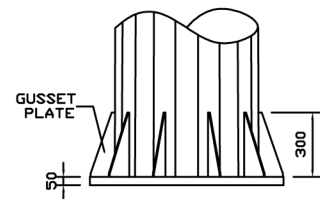

BASE FLANGE  
STIFFENED WITH GUSSET PLATE

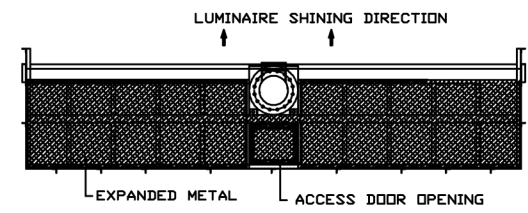

PLATFORM PLAN

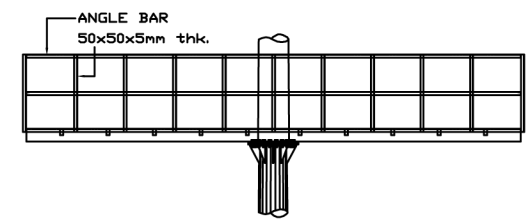

PLATFORM ELEVATION

**SPECIFICATION**

- 1) STADIUM MAST DIMENSION
  - 1.1 MOUNTING HEIGHT = 35M
  - 1.2 CROSS SECTION SHAPE (NO OF SIDES) = 20
  - 1.3 MAX. TOTAL NO OF SECTIONS = 5
  - 1.5 SERVICE DOOR DIMENSIONS
    - 1.5.1 LENGTH = 1200mm
    - 1.5.2 WIDTH = 300mm
    - 1.5.3 DOOR BOTTOM FROM GROUND LEVEL = 600mm
  - 1.6 DOOR OPENING TO BE REINFORCED HEAVILY TO PREVENT BUCKLING = YES
  - 1.7 ANTI-VANDALISM DOOR LOCK = YES
- 2) CONFIRMING STANDARDS
  - 2.1 MAST DESIGN = AS/NZS 1170
  - 2.2 MATERIAL = AZ/NZS 4600
  - 2.3 WELDING (ELECTRIC ARC WELDING) =
  - 2.4 GALVANISING = AS/NZS 4680
- 3) DESIGN CONDITIONS
  - 3.1 DESIGN BASIC WIND SPEED = 33.3M/S AT 10M HEIGHT
  - 3.2 UNFACTORED ON DESIGN WIND SPEED
  - 3.3 SAIL AREA PER FITTING = 0.3M2
  - 3.4 NUMBER OF FITTING = 60
  - 3.5 TOTAL SAIL AREA FOR FITTINGS = 18.0M2
  - 3.6 SAIL AREA FOR HEADFRAME AND PLATFORM = 5.0M2
  - 3.7 TOTAL DESIGN SAIL AREA = 23.0M2
- 4) FOUNDATION DESIGN  
THE FOUNDATION DESIGN SHOULD BASE ON THE SOIL BEARING CAPACITY AND GROUND REACTION DUE TO DESIGN WIND LOAD.
- 6) TESTING PROCEDURES = DIMENSIONAL VERIFICATION  
GALVANISING THICKNESS  
MATERIAL THICKNESS

**NOTES :**  
THE EXACT DIMENSIONS OF LUMINAIRES SUPPORTING STRUCTURE SHALL BE SUBJECT TO THE NUMBER AND RATINGS OF LUMINAIRES REQUIRED BY STADIUM LIGHTING SPECIALIST.

REV	DATE	BY	DESCRIPTION
PROJECT			
OWNER			
ELECTRICAL CONTRACTOR			
DOYES ENGINEERING SDN BHD			
DRAWING TITLE			
35M STADIUM POLE			
MANUFACTURER			
GALVANISED POLES AUSTRALIA			
45 Briggs Street, Welshpool, Western Australia 6106			
P: 1300 790 343			
E: sales@galvanisedpolesaustralia.com			
www.galvanisedpolesaustralia.com			
DRAWN BY : D.C.		DATE : 22-04-2010	
SCALE : D.C.		CHKD. BY : D.C.	
DRAW NO. : SM preliminary			REVISION
			00